

# 5400 SERIES: K2 COMMERCIAL VINYL SLIDING & SWING DOOR SYSTEMS

## HIGH PERFORMANCE DOORS

Innovative Technologies.  
Superior Performance.



### COMMERCIAL RATED

The 5400 Series K2 vinyl in- & out-swing and sliding door systems are optimally configured to meet critical specifications for use in large sizes and where high structural ratings are necessary. Their multi-chambered profiles are designed with long-lasting .100" thick walls to better withstand higher pressure loads. The frames can be mechanically assembled or welded, and the equal glass unit sightlines will provide a more pleasing aesthetic look. These door systems will help you better compete in the commercial, higher-load, entry and patio door market where you can source additional market share.

### ADD-A-TRACK OPTION

Perfect for high-rise and hurricane coastal applications, such as hotels, multifamily buildings, condominiums, businesses and residences

Collaborate with Quanex today and start taking advantage of our team's expertise and ongoing support.  
[WWW.QUANEX.COM](http://WWW.QUANEX.COM)

Specify Thermal Performance, Design Versatility and Structural Strength

[www.Quanex.com](http://www.Quanex.com)



**Quanex**  
building products

# 5400 SERIES: K2 COMMERCIAL VINYL IN- AND OUT-SWING DOOR SYSTEMS

## TESTED TOUGH

Tested to meet AAMA commercial standards achieving C30 rating for 8 foot height double panel configuration

Structural Testing In-swing Door (SGD) AAMA/NWWDA 10/I.S.2-97

| PRODUCT   | NOMINAL SIZE | NET SIZE (IN.) | CONFIGURATIONS | RATING |
|---|--------------|----------------|----------------|--------|
|  | 3'0" x 8'0"  | 36" x 96"      | X              | C30    |
|  | 6'4" x 8'0"  | 76" x 96"      | XO             | C30    |
|   | 6'4" x 8'0"  | 76" x 96"      | XX             | C30    |

## DESIGN FEATURES

- 3 frame configurations (5-3/8" frame depth with nail fin setback of 1-1/8", 1-1/2" and no nail fin)
- Multi-chambered profiles with 0.100" wall thickness for sturdy corner welds and maximum thermal performance
- Standard 3-1/2" and 5" style and rail widths
- Equal glass and sight lines
- Accepts multi-glazing options, including insulated or monolithic
- Frame can be mechanically assembled or welded
- Accepts multiple hardware options

## DOOR CONFIGURATIONS

- Single and double panel configurations up to 8 feet high and 6 feet wide
- X, XO and XX configurations
- Available mull and transom window configurations

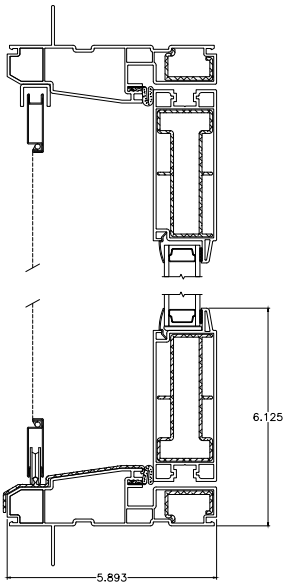
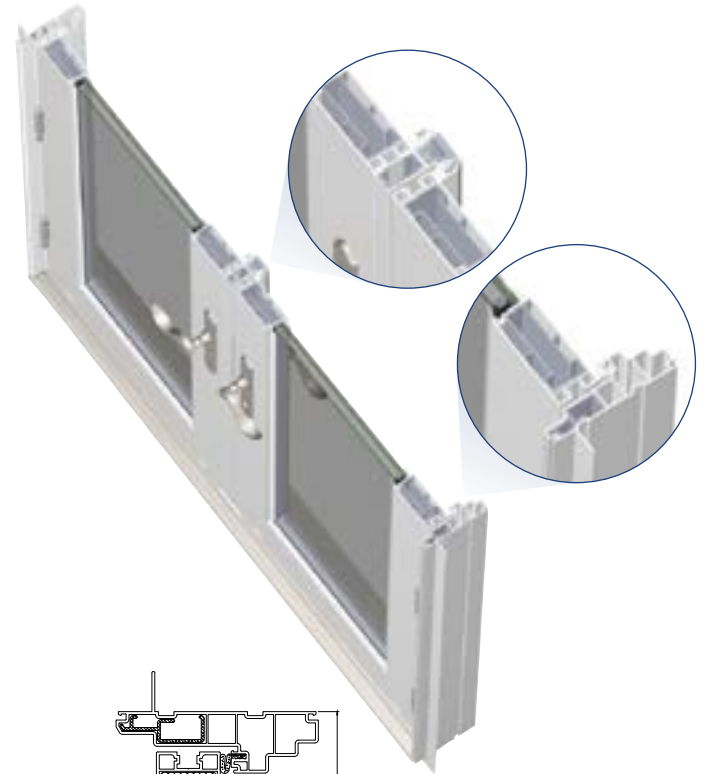

**K2 IN-SWING VERTICAL CROSS SECTION**

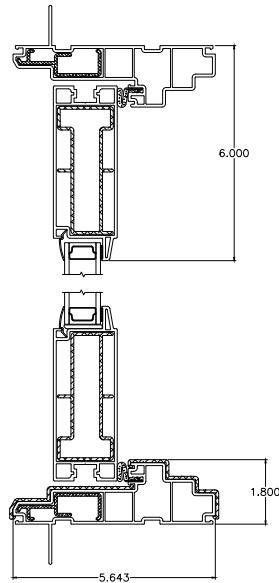

**K2 OUT-SWING VERTICAL CROSS SECTION STANDARD SILL**

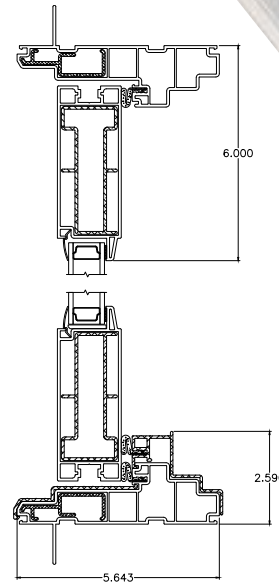

**K2 OUT-SWING VERTICAL CROSS SECTION HIGH-PERFORMANCE SILL**

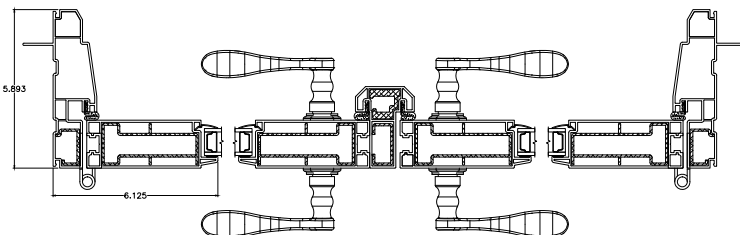

**K2 IN-SWING HORIZONTAL CROSS SECTION**

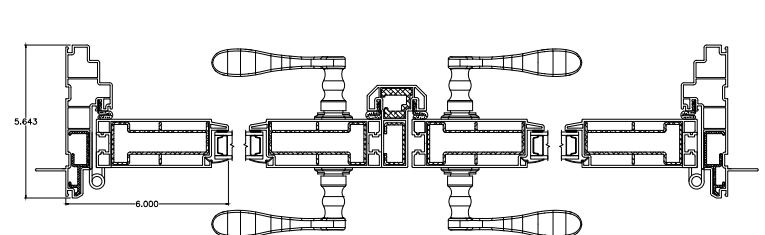



**K2 OUT-SWING HORIZONTAL CROSS SECTION XX**

# 5400 SERIES: K2 COMMERCIAL VINYL SLIDING DOOR SYSTEMS

## TESTED TOUGH

Thoroughly tested to AAMA standards, the 5400 series K2 sliding door has achieved an HC50 rating for 8 foot heights and a C35 rating for 10 foot heights in multiple panel configurations.

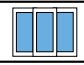
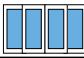
| STRUCTURAL TESTING PER AAMA/WDMA/CSA 101/I.S.2/A440-08 |  |      |       |        |  |
|--|--|------|-------|--------|--|
| Size   | Configuration  | Air  | Water | Rating |  |
| 96" x 96"  | XO, OX  | 0.12 | 7.52  | R-PG50 |  |
| 96" x 96"  | XX      | 0.02 | 7.52  | R-PG50 |  |
| 144" x 96"   | OXO     | 0.07 | 6.89  | R-PG45 |  |
| 192" x 96"   | OXXO    | 0.10 | 6.89  | R-PG45 |  |

## DESIGN FEATURES

- Multi-chambered profiles for strong weather-tight corner welds and maximum thermal performance.
- Accepts multiple glazing options. Can be glazed monolithic or insulated.
- Available configurations to meet Coastal Miami-Dade impact ratings.
- Meets ASTM E1886 and E1896 Impact Certification.
- 5-3/8" frame depth (no fin).
- Stainless steel roller capability.
- Accepts multiple hardware options.
- Available in 3-1/2" or 5" panel widths.



## DOOR CONFIGURATIONS

- The 5400 series K2 door is available in 2, 3, and 4 panel configurations up to 10 ft. high and 20 ft. wide.
- Available in mull and transom window configurations.

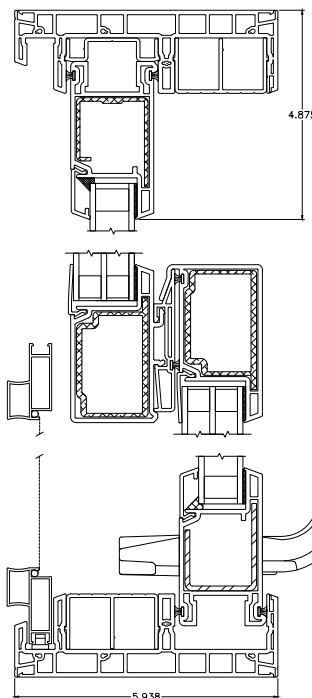
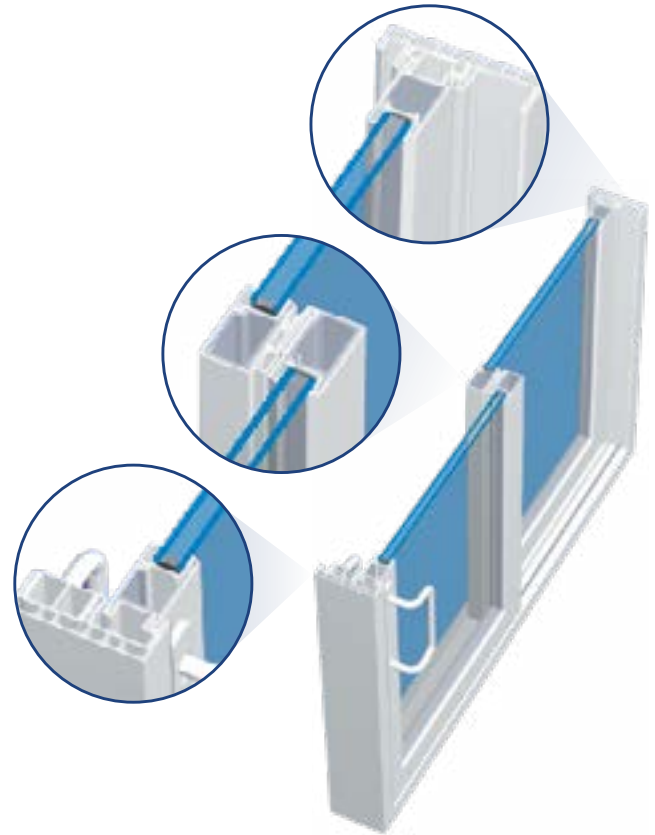

**K2 SLIDING HORIZONTAL CROSS SECTION**

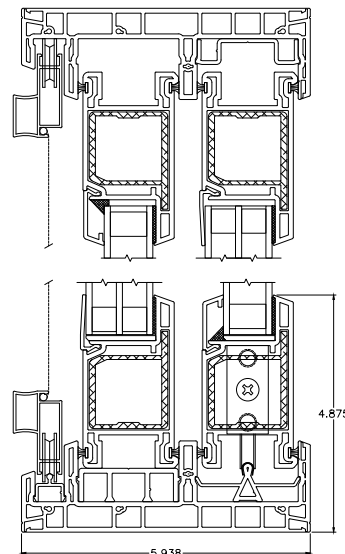

**K2 SLIDING VERTICAL CROSS SECTION**

# 5400 SERIES: K2 COMMERCIAL VINYL SLIDING ADD-A-TRACK OPTION

## BEAUTIFUL & FUNCTIONAL

Quanex's Mikron 5400 Series K2 vinyl sliding door with Add-A-Track Extenders has opened up a new world of possibilities for commercial fabricators, architects, designers and end users who want to blur the line between indoor and outdoor environments. The system allows users to open multiple panes of glass for a wider, more extensive view of the outside by accommodating unlimited tracks and virtually unlimited design possibilities.

Unlike ad hoc systems designed on site, the Quanex K2 system is engineered to meet the toughest standards, including LC-PG50. And since it is vinyl, it is energy efficient and will never pit, warp, rot, corrode, peel or crack, making it a highly sustainable solution.

## HIGH STRENGTH TO MEET CRITICAL SPECIFICATIONS

- Designed to meet critical specifications for use in large sizes and where high structural ratings are a necessity
- Can be used with standard aluminum or steel reinforcing for maximum stiffness and stability
- Built with long-lasting .100" thick walls, multi-chambered frame profiles
- Available in multi-panel configurations up to 10 feet high and 20 feet wide using the Add-A-Track Option
- Available in mull and transom window configuration

## DESIGN FEATURES

- Multi-chambered profiles for strong weathertight corner welds and maximum thermal performance
- Accepts multiple glazing options. Can be glazed monolithic or insulated
- No fin, 1" nail fin set back, and w1-3/8" nail fin set back available
- Stainless steel roller capability
- Accepts multiple hardware options
- Available in 3-1/2" panel widths

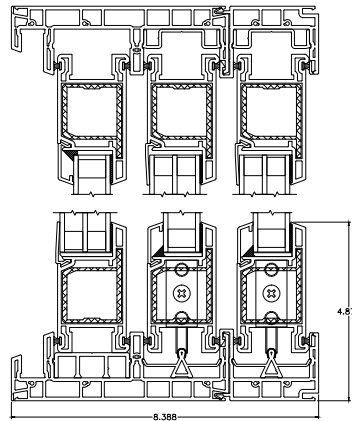
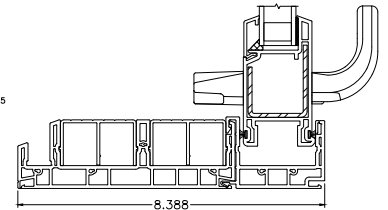
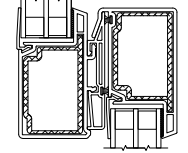
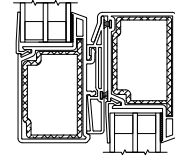
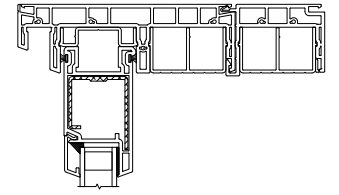

VERTICAL CROSS SECTION

HORIZONTAL CROSS SECTION

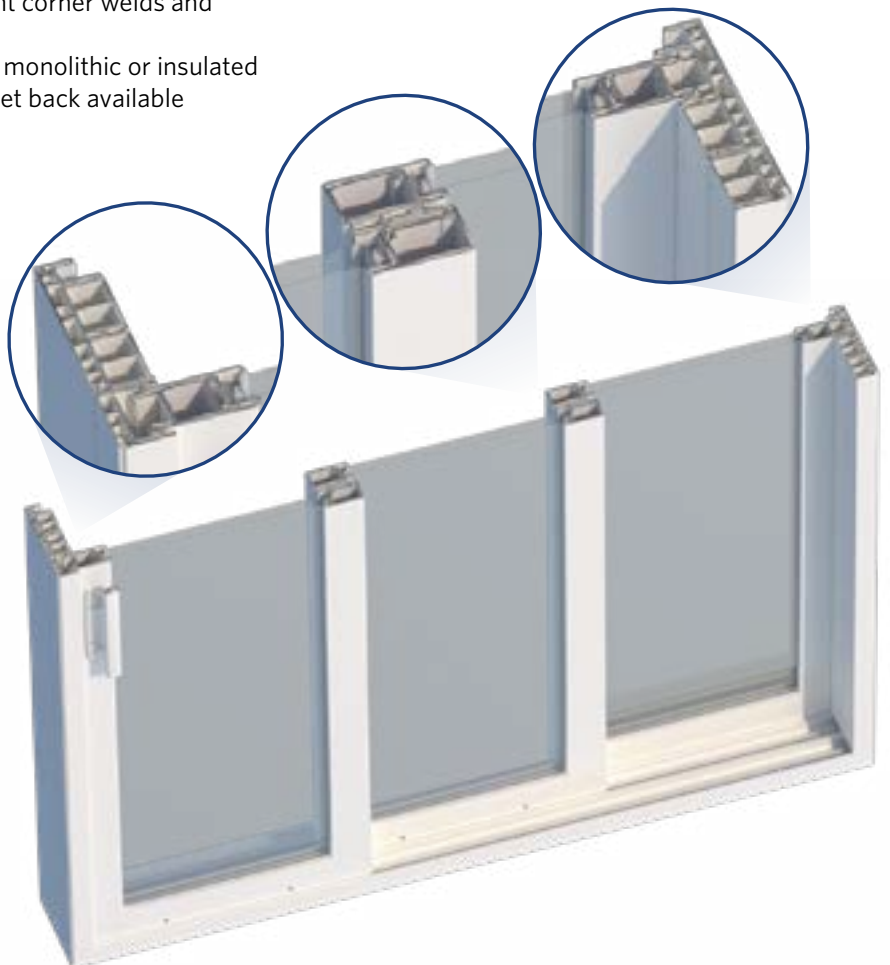

# 5400 SERIES: K2 COMMERCIAL VINYL SLIDING & SWING DOOR SYSTEMS

## HIGH PERFORMANCE DOORS

### HIGH STRENGTH TO MEET CRITICAL SPECIFICATIONS

- This high-strength vinyl door system has been designed to meet critical specifications for use in large sizes and where high structural ratings are a necessity.
- 5400 series K2 door vinyl extrusions accept standard aluminum or steel reinforcing. This heavy-duty construction assures the stiffness and stability needed in high load applications.

### MIKRONBLEND® TEST- AND PERFORMANCE-PROVEN

All Quanex extrusions feature proprietary MikronBlend® vinyl compound. Formulated to withstand the toughest conditions and standards, it is tested tough and real-world proven for over 50 years. You will find windows with Quanex frames in the harshest field test environments: the hot, dry Arizona desert, Florida heat and humidity, and Midwest weather and temperature extremes.

Additionally, ASTM test procedures verify MikronBlend® Delta-E performance. Windows and doors featuring MikronBlend vinyl surpass strict industry measures for color fastness and UV degradation and won't chalk or appreciably fade, even after years of weather performance.

**The In- and Out-swing systems** are available in white, adobe, or almond MikronBlend® vinyl compound.

**The Sliding and Add-a-Track systems** incorporate superior, patent-pending, solar-reflective color technology, SuperCapSR™ color technology, which absorbs less heat to prevent heat-related profile distortion, for both interior and exterior profile surfaces, including popular commercial colors: architectural bronze, silver (replicating a clear anodized aluminum finish), and black. Also available in white, adobe, or almond MikronBlend® vinyl compound. Custom options are available.

#### MikronBlend



#### SuperCapSR

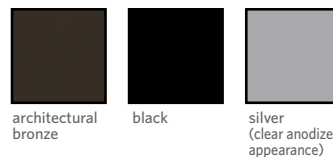

*\*Printing limitations prevent exact color duplication. Contact your Quanex representative for color samples.*



#### FGIA Standards:

- AAMA 613 for Color Retention
- AAMA 614 for Weathering
- AAMA 615 for Durability, testing to 12x harder than competitive paint coatings
- Tested and passed per ASTM: D3363, D4214, D2247, D4585, D714, D523, D4726, D3359, D4803 and D968.



# Quanex

building products

Quanex Building Products  
Window and Door Systems  
1034 6th Avenue North, Kent, WA 98032  
(800) 456-8020

[www.Quanex.com](http://www.Quanex.com)



Specify Thermal Performance, Design Versatility and Structural Strength



© 2009 Quanex Building Products • REV 02/2020  
MikronBlend® is a registered trademark of Quanex Building Products  
SuperCapSR™ are trademarks of Quanex Building Products

[www.Quanex.com](http://www.Quanex.com)